

Hunter®

PRO-HC IRRIGATION CONTROLLER

 HydraWise™ Ready



Quick Start Guide

hunterindustries.com

TABLE OF CONTENTS

Installation	3
Connecting AC Power	5
Connecting Station Wires	7
Connecting Sensors or Flow Meters	8
Connecting to a Wi-Fi Network	9
App Configuration	10

PRO-HC SUPPORT

Thank you for purchasing the Hunter Pro-HC Controller. This Quick Start Guide will help you install and configure the Pro-HC Controller and connect to Wi-Fi. For support of the Hydrowise™ cloud software or help with your Hydrowise account, please visit hunter.direct/prohchelp.

Your Pro-HC box contains:

- A Pro-HC Wi-Fi controller
- 24V AC transformer (Indoor Model) or Built-in Transformer (Outdoor Model)
- 2 screws and 2 wall anchors for wall mounting

INSTALLATION

Installing the Pro-HC Controller

Start by choosing a location with good Wi-Fi coverage. Wi-Fi coverage can be easily tested using a smartphone. A signal strength of 2 or 3 bars is recommended. Wi-Fi connectivity can also be tested on the Pro-HC itself (signal strength is shown when you select a wireless network).

Mounting the controller to a wall

All necessary hardware is included for most installations.

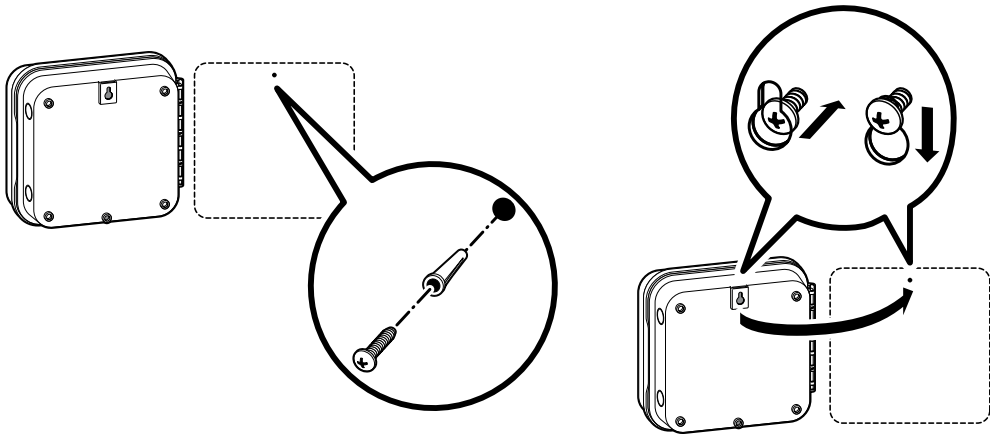

Mounting the controller to a wall *(continued)*

Use the hole at the top of the controller as a reference and secure a 1" (25 mm) screw into the wall. **Note:** Install screw anchors when attaching the controller to drywall or masonry wall.

Align controller with the screw and slide the keyhole on top of the controller over the screw.

Secure controller in place by installing screws in the other mounting holes.

For Pro-HC601-A, Pro-HC1201-A and Pro-HC2401-A : If the supply cord is damaged, it must be replaced by the manufacturer or service agent or a similarly qualified person to avoid hazard.

CONNECTING AC POWER

Indoor cabinet

Route transformer cable through the hole on the bottom left side of the controller and connect one Yellow Wire to each of the screws marked 24AC and the Green Wire to GND.

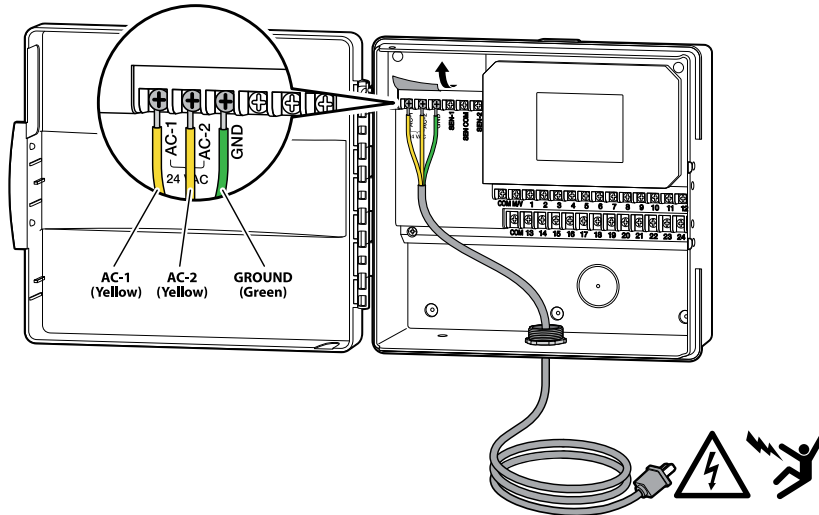

Note: The indoor Pro-HC is **not** water or weather resistant, and must be installed indoors or in a protected area. This device is not intended for use by young children. Never let children play with this device.

Outdoor cabinet

The outdoor model is water and weather resistant. Connecting the outdoor Pro-HC to the primary power should be done by a licensed electrician following all local codes.

Route AC power cable and conduit through the ½" (13 mm) conduit opening on the left side of the bottom of the cabinet.

Connect the wires to the transformer wires located inside the junction box. International units are supplied with a built-in terminal strip. Always use a UL listed conduit ½" (13 mm) male adapter when installing the AC wiring.

Insert the adapter into the ½" (13 mm) hole at the bottom of the controller. Attach a nut to the adapter inside the enclosure.

A battery is not required for this controller. Watering will not occur without AC power. Since this controller has non-volatile memory, the program, clock and calendar will be retained during a power outage.

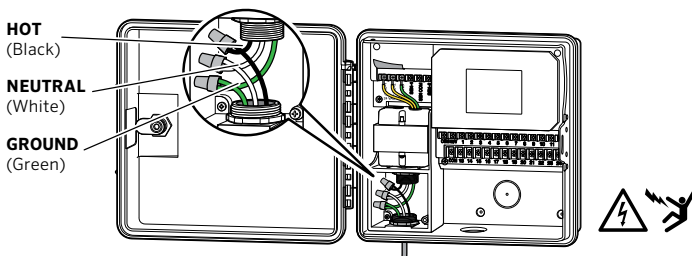

Note: To be performed by a licensed electrician only. Always use UL listed ½" (13 mm) conduit with male adapter when installing AC wiring. Pro-HC controllers are intended to be supplied AC power with an over-current protected device. Improper installation could result in shock or fire hazard. This device is not intended for use by young children. Never let children play with this device.

CONNECTING STATION WIRES

Route valve wires between control valve location and controller.

At valves, attach a common wire to either solenoid wire of all valves. This is most commonly a white-colored wire. Attach a separate control wire to the remaining wire of each valve. All wire splice connections should be done using waterproof connectors.

Route valve wires through the conduit and attach conduit to one of the openings on the bottom of the cabinet.

Strip $\frac{1}{2}$ " (13 mm) of insulation from ends of all wires. Secure the valve common wire to "COM" (Common) terminal. Attach all individual valve control wires to the appropriate station terminals.

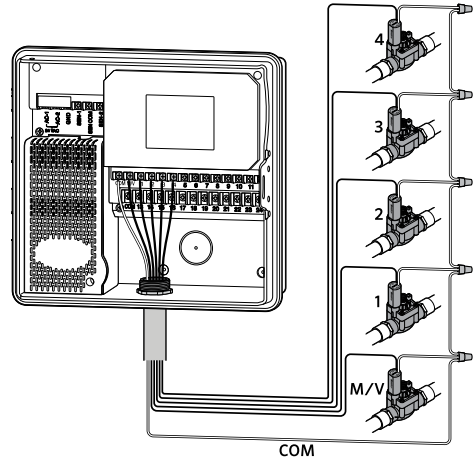

Note: All wire connections should be done using waterproof connectors. Connect each of the other individual wires to a different colored wire. Record zones against wire color for later reference. Connect the common wire from the multicore cable (usually white) to the terminals on the controller marked COM.

CONNECTING SENSORS OR FLOW METERS (OPTIONAL)

Pro-HC Controller supports most open/closed contact type of sensors such as Hunter rain and soil moisture sensors.

Connect one sensor wire to COMMON on the controller.

Connect the Normally Closed or Normally Open wire from the sensor to SEN-1 or SEN-2 on the controller and configure in the Hydrawise app.

Wiring for standard Hydrawise 0.75" (20mm) or 1" (25mm) flow meters is as follows:

Flow Meter Wire	Label on Controller
Blue	SEN-1, SEN-2
White	SEN COM
Red	Not connected

For full details, refer to the instructions provided with your sensor, or flow meter.

Once you've wired your sensor you must configure it in your Hydrawise account.

See Configuring Sensors [hydrawise.com/support](https://www.hydrawise.com/support) for full instructions on setting up sensors.

Wiring for open/closed contact sensors is as follows:

Sensor Wire	Label on Controller
Normally Open / Normally Closed wire	SEN-1, SEN-2
Second (common) wire	SEN COM

CONNECTING TO A WI-FI NETWORK

When your controller is first powered on, it will run a short wizard to connect it to your wireless router.

If you're not using the initial startup wizard, then go to the Wireless Settings section to make changes. For support, please contact hunter.direct/prohchelp.

Using the wizard



Select your wireless network from the list shown on the controller display and press the **Confirm** button on screen.





Note: If your network is not listed, then check if the unit is within wireless range.

Enter your wireless password and press the OK button on keyboard.



Note: Make sure you press the OK button after you've entered your password. Pressing the Home  or Back  buttons will not save your changes.

When connecting to your wireless network, the Wi-Fi Icon  at the bottom right of the controller screen will flash. Connecting takes about 30 seconds and when successfully connected the Wi-Fi Icon  will stop flashing and stay on.

HYDRAWISE APP CONFIGURATION

To connect the Pro-HC Controller to the Hydrowise app, follow these steps and then follow the on-screen instructions.

Register for an Account Online

If you have not already done so, go to Hydrawise.com and register for an account.

Log into Your Account

If this is your first time logging in, you will be guided through a setup wizard to help you with initial configuration of your controller.

The owner's manual and app instructions are located here: Hydrawise.com/support

Canadian FCC Statement

This device complies with Industry Canada license-exempt RSS standard(s). Operation is subject to the following two conditions: (1) this device may not cause interference, and (2) this device must accept any interference, including interference that may cause undesired operation of the device.

US FCC Statement

This equipment has been tested and found to comply with the limits for a Class B digital device, pursuant to part 15 of the FCC Rules. These limits are designed to provide reasonable protection against harmful interference in a residential installation. This equipment generates, uses and can radiate radio frequency energy, and if not installed and used in accordance with the instructions, may cause harmful interference to radio communications. However, there is no guarantee that interference will not occur in a particular installation. If this equipment does cause harmful interference to radio or television reception, which can be determined by turning the equipment off and on, the user is encouraged to try to correct the interference by one or more of the following measures:

- Reorient or relocate the receiving antenna.

- Increase the separation between the equipment and receiver.

- Connect the equipment into an outlet on a circuit different from where the receiver is connected.

- Consult the dealer or an experienced radio/TV technician for help.

To satisfy FCC RF Exposure requirements for mobile and base station transmission devices, a separation distance of 20 cm or more should be maintained between the antenna of this device and persons during operation. To ensure compliance, operation at closer than this distance is not recommended. The antenna(s) used for this transmitter must not be co-located or operating in conjunction with any other antenna or transmitter.

TROUBLESHOOTING

Need more helpful information on your product?
Find tips on installation, controller programming and more.



hunter.direct/prohchelp